



SPECIFICATIONS

Rated Current:3.0AMP
 Contact Resistance:20mΩ Max
 Withstand Voltage:1000V AC/DC
 Insulation Resistance:1000MΩ Min
 Operation Temperature:-40°C to +105°C

Contact Material:Brass
 Contact Plating:Au or Sn Over Ni
 Insulator Material:Polyester(UL94V-0)
 Standard: PA6T
 Max.Processing Temp: 230°C for 30-60 seconds
 (260°C for 10 seconds)

Recommended P.C.B Layout(Top Side)
 (PCB BOARD TOLERANCE±0.05)

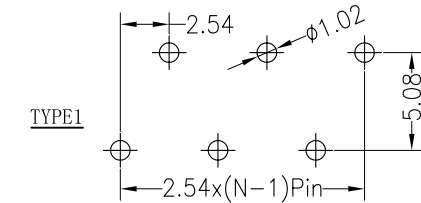
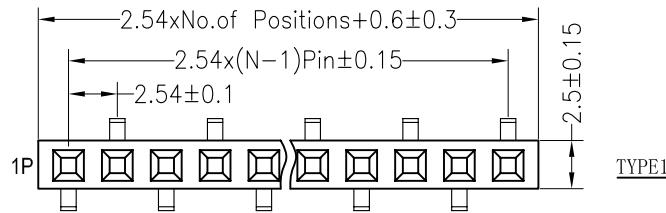
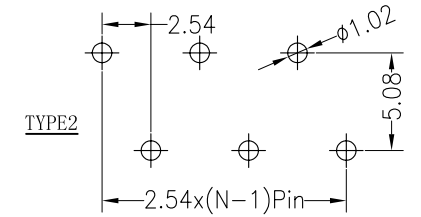
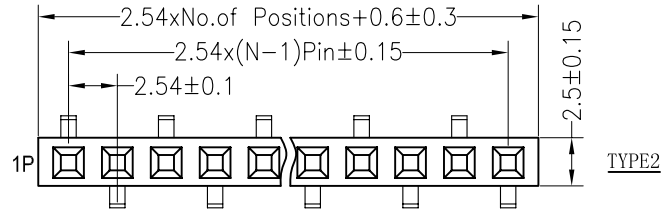

Ordering Information

2250 01 XX X N XX W U X 0X(1,2)

- No. of Pins Per Row 1*40
- Insulator Material Option: A=BK-PBT, B=BK-PA66, C=BK-PA6T, D=BK-PA46, F=BK-LCP
- Contact Plating: G0:Gold Flash, G2:5U" Gold, G3:10U" Gold, G4:15U" Gold, G5:30U" Gold, S0:Gold Flash/Tin, SN:Tin
- Packing: 0=PE Bag, T=Tube, P=Tube+Cap, R=Reel+Cap, M=Reel+Mylar

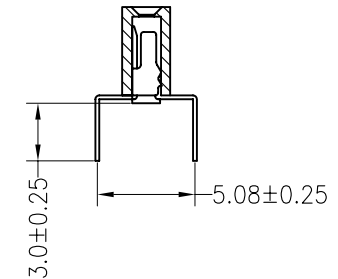
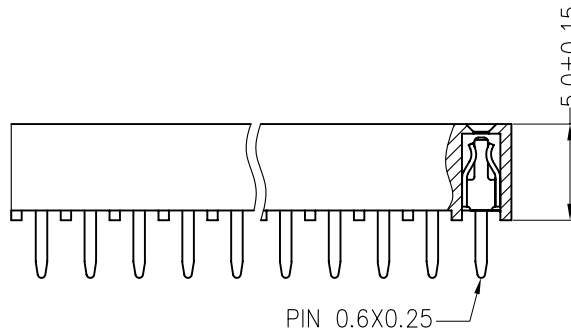

				OPERATION		DRAW	YiYuSheng	15.01.22	SCALE	FIT	JiLN ® 深圳市锦凌电子有限公司 SHENZHEN JINLING ELECTRONIC CO.,LTD Tel: 86-755-2997-5806/5802 Fax: 86-755-2997-5992	
				X.X	±0.30				UNIT	mm		
				X.XX	±0.20	CHECK			SIZE	A4	PART NO.	225001XXXXXXWUX0X(1,2)
				X.XXX	±0.10				SHEET	1/1	TITLE:	2.54PF H5.0mm 1xNpin SMT W2.50 蜈蚣脚端子
REV	DATE	MODIFICATION DESCRIPTION	CHANGE	Angle	±3°	APPROVE			PROJ.	◆		
DIM	TOL											